



DIY SELF-SERVICE GUIDE

HOW TO REMOVE AND REPLACE A SCREEN - FIBERGLASS WINDOWS (PULL TAB)



Materials Required:

None



Difficulty:

Easy



Time Requirement:

5 minutes

INSTRUCTIONS:

1. Walk up to the window on the interior of the home.
2. Fully open the window.
3. You'll see pull pins on the top and bottom.

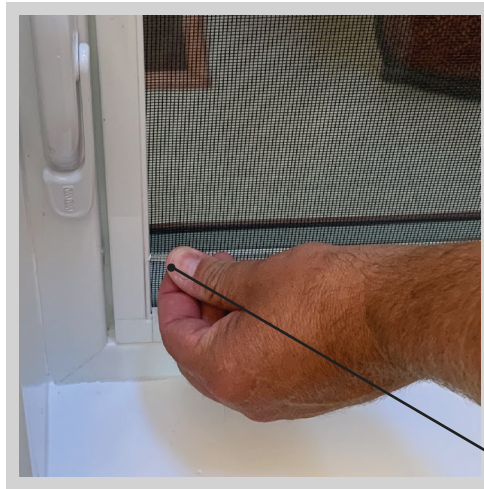
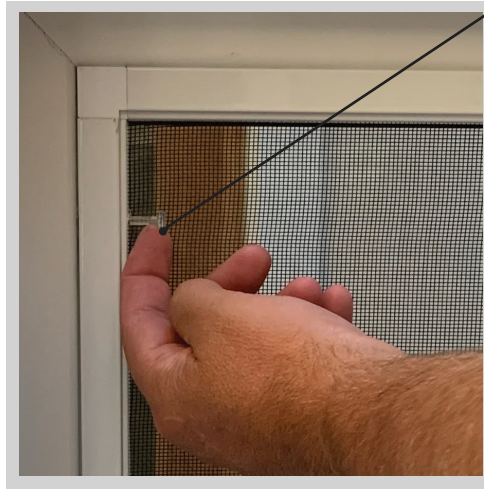

PULL PINS

PULL PINS

4. Pull pins towards center on the top and then the bottom.

5. Pull the screen away from center and it will come free.



PULL IN TOWARDS CENTER

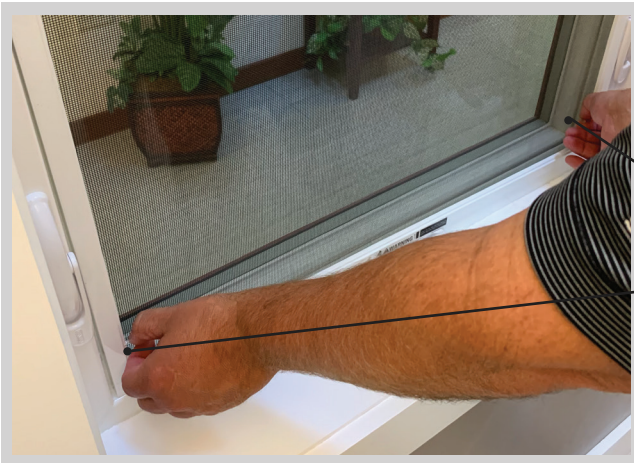

PULL IN TOWARDS CENTER



PULL SCREEN AWAY

6. To reinsert, pull the pins in, insert the bottom. Pull the top pins in and insert the top.

