



HOW TO INSTALL AND ADJUST ROLLERS FOR A HORIZONTAL SLIDING WINDOW

DIFFICULTY



Moderate

TIME REQUIREMENT

15 Minutes



HOW TO INSTALL AND ADJUST ROLLERS FOR A HORIZONTAL SLIDING WINDOW

Materials Required:

- Flat head screwdriver
 - Silicone spray
 - Paper towels
 - Safety glasses and gloves
-



For a list of window terms please go to Milgard.com/How-To-Speak-Window

Safety Precautions:

This activity is appropriate for individuals with an understanding of how to use simple hand tools. Remember to wear eye protection and to make sure that pets and small children are not present when performing these activities.

Instructions:

Occasionally adjustments may be needed to maintain smooth window operation. Roller adjustment may be necessary to ensure a proper level sash reveal.

Vinyl

1. Open sash completely
2. Remove the sash from the frame by lifting up on the sash and tilting the bottom out of the track. (Image 1)
3. On the bottom of your window there are two assemblies containing vinyl wheels. (Image 2) Each assembly has two position for each wheel. Using a flat head screwdriver remove the wheel by snapping it out of the wheel casing. (Image 3)



Image 1



Image 2

Continued on next page

HOW TO INSTALL AND ADJUST ROLLERS FOR A HORIZONTAL SLIDING WINDOW

4. Raise or lower the wheel to the desired height and snap them back into place.
5. Once the wheels are snapped back into place, clean your rollers. Make sure the wheels roll back and forth and there is no dirt or debris in them.
6. Spray your wheels with a small amount of silicone spray.
7. Take a paper towel and wipe down the rollers to ensure there is no excess silicone.
8. To reinstall the sash, tilt the top of the sash and insert into the top of the track. Carefully insert the bottom of the sash and push down into the bottom track. Check the sash by sliding it back and forth.

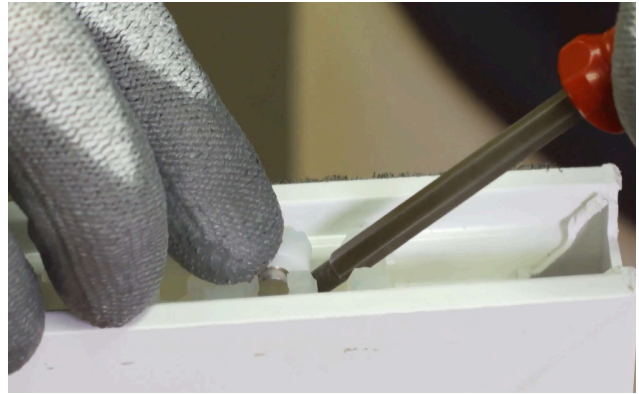

Image 3



Image 4