

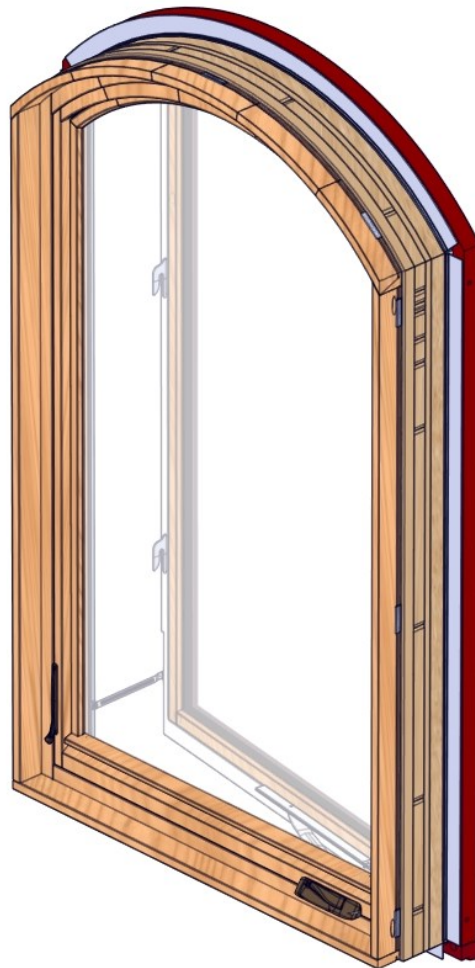

Clearly the best.®

Arch Frame Windows

Interior Wood Trim Removal and Replacement





Clearly the best.

Table Of Contents

Required Tools 3

Wood Removal Overview 4

Cover Removal 5

Cover Replacement..... 7

Frame Fascia Wood Removal 10

Frame Fascia Wood Replacement 11

Wood Glazing Bead Removal 12

Wood Glazing Bead Replacement 13

Mullion Cover Removal and Replacement 14

Revisions 15

Required Tools

User Supplied

Required Tools

- Screwdriver with #3 PoziDrive
- Screwdriver with #2 Phillips Bit
- Screwdriver with Square Bit
- Screwdriver with small flat blade
- Putty Knife
- Rubber Mallet

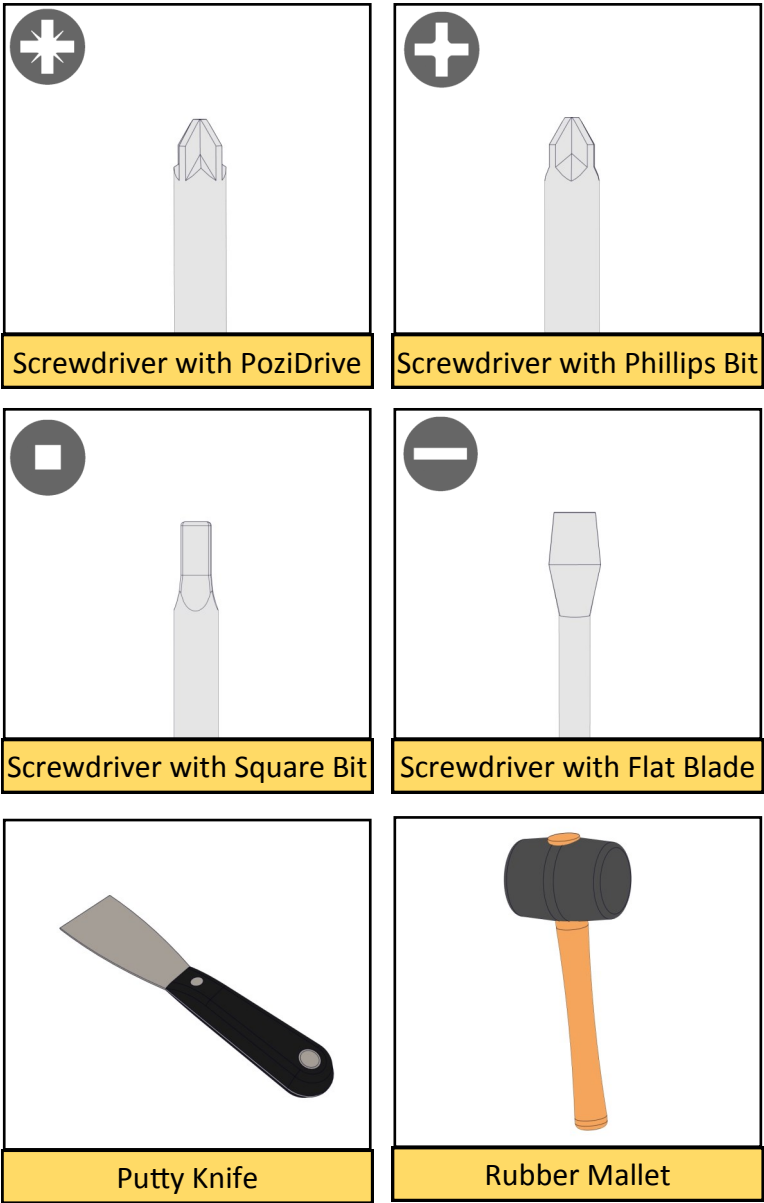

Wood Removal Overview

Interior wood components on the Milgard Essence Radius Top/Gable Windows may be removed for various reasons, such as, but not limited to:

- Installing window
- Removing or replacing sash
- Removing or replacing operator
- Removing or replacing lock bar
- Removing or replacing lock mechanism
- Removing, replacing or adjusting hinges
- Staining or Painting

Included in this manual are instructions for removal and replacement of the following wood components:

- Sill, Header and Jamb Covers
- Wood Glazing Bead with and without grids
- Wood Fascia Frame
- Mullion covers

Note:



- ◆ After removing any of the wood components, place wood in a safe place to avoid damage.

Cover Removal

Removing Covers (Butt Joint Corners)

- Loosen set screw, remove operator handle, then remove escutcheon from sill by lifting off with hands.
- Remove lock handle by pulling outward, then remove escutcheon by prying outwards with putty knife.
- Using a putty knife, slide tool between Sill Cover and Wood Fascia, then pry upwards on tool. See cautionary note on page 7.

Note:

- ♦ When cover connectors are encountered while prying and sliding putty knife around window, remove tool and re-insert approximately 2" further along path and resume prying.
- Slide tool along window sill and continue to pry up.
- Remove cover by pulling away from frame.
- On Arch-top windows, there are two wood plugs in the header screen retaining groove that hide two screws.
- Remove plugs and screws.
- Remove header cover using a putty knife to insert between header cover and wood fascia.
- Pry down and remove trim by pulling away from frame.

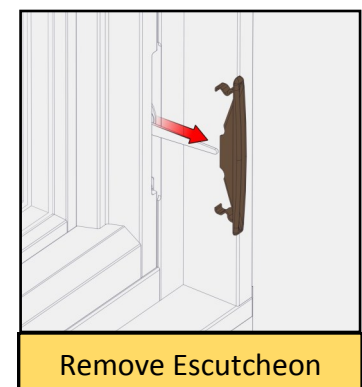
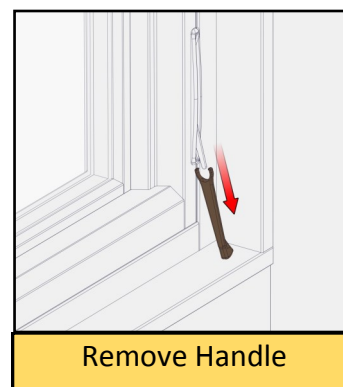
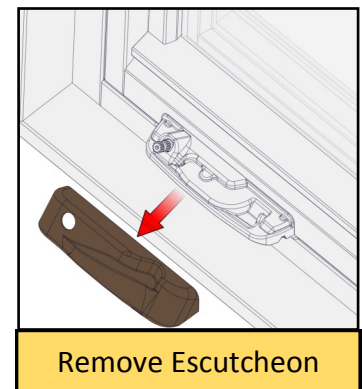
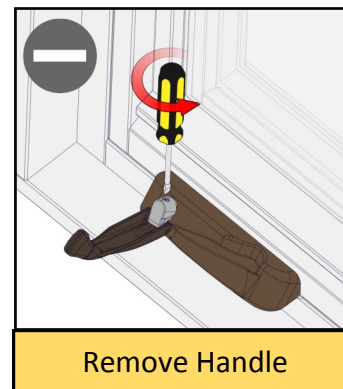
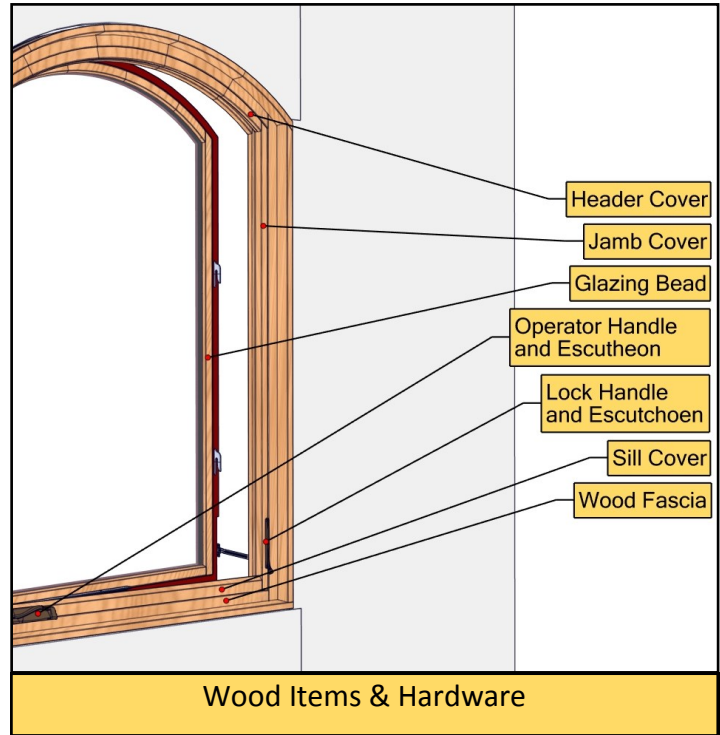

Cover Removal (Continued)

- After removing sill and header covers, remove jamb cover.
- Remove jamb cover by slipping putty knife between jamb cover and wood fascia near bottom of window.
- Pry inwards (away from jamb), slide tool towards top of window, and continue prying inward.
- Remove cover by pulling away from frame.

Round Top Only (Miter Joint Corners)

- On Round-Top windows only, jamb covers must be removed before header. After removing sill cover, remove jamb covers.
- Remove jamb cover by slipping putty knife between jamb cover and wood fascia near bottom of window.
- Pry inwards (away from jamb), slide tool towards top of window, and continue prying inward.
- Remove cover by pulling away from frame.

Note:



- ♦ Prying with putty knife against the Wood Fascia Frame may crack or break the edge. Always pry away from fascia wood.

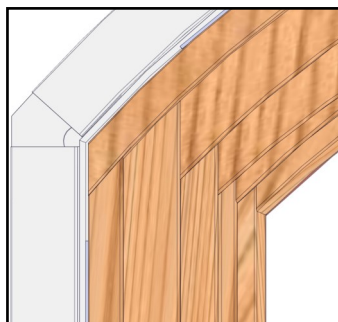

Arch Top Butt Joints

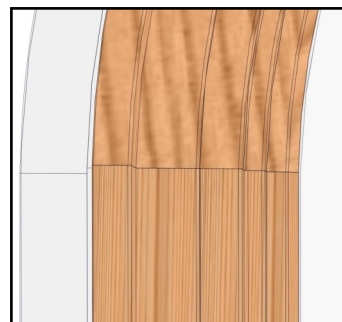

Round Top Miter Joints

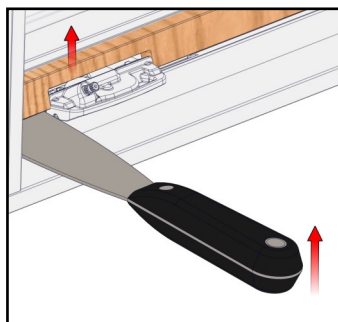

Sill Cover Removal

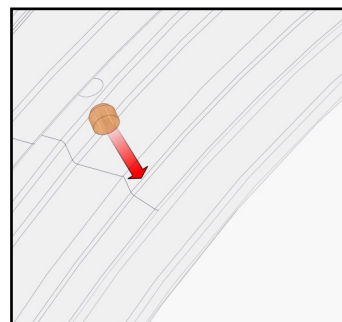

Remove Plug



Head Screw Removal

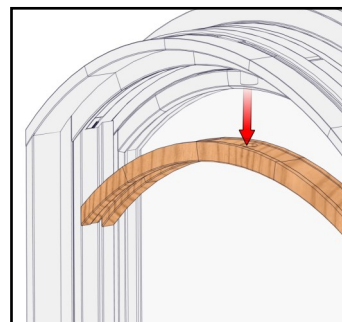

Head Cover Removal

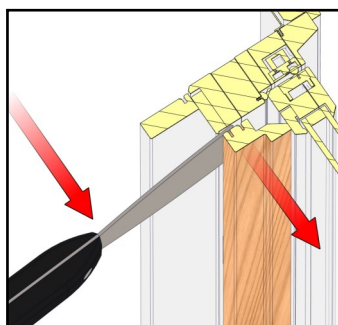

Jamb Cover Removal

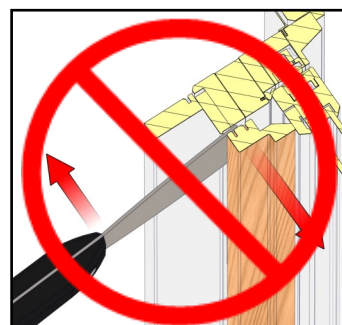

Do Not Press on Fascia!

Cover Replacement

Dual Lock

- If dual-lock interlocking strips, FA760501, are not present on head of frame or wood heads, adhere the required number of dual-lock interlocking strips by removing adhesive liner and pressing into fabricated slots at head of frame.
- Interlock the same quantity of dual-lock strips onto the strips already attached to frame.
- Remove adhesive liner from dual-lock strips.

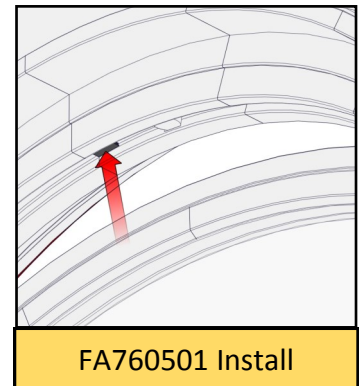

Arch Top Windows (Butt Joint Corners)

- Place base of strike-side jamb cover on sill.
- While aligning jamb cover kerfs with wood connectors, use heel of hand or non-marking rubber mallet and a block of wood to seat jamb cover firmly against frame.
- Repeat for opposite jamb cover (if previously removed).
- Place sill cover ends against jamb covers.
- Use heel of hand or non-marking rubber mallet and a block of wood, tap sill cover down, ensuring sill cover kerf aligns with wood connectors.
- Place header cover ends against jamb covers.
- Using heel of hand or non-marking rubber mallet and a block of wood, tap header cover into place.

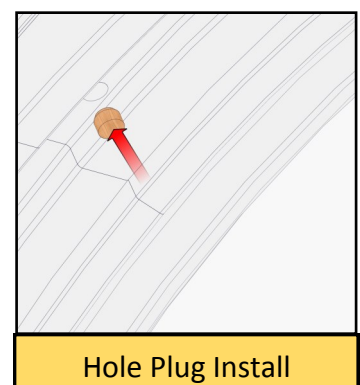
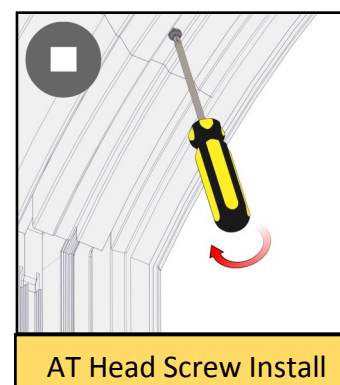
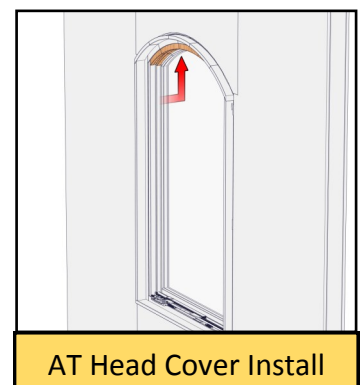
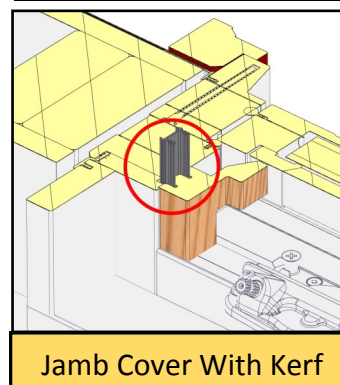
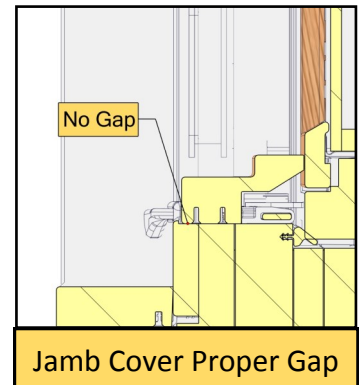
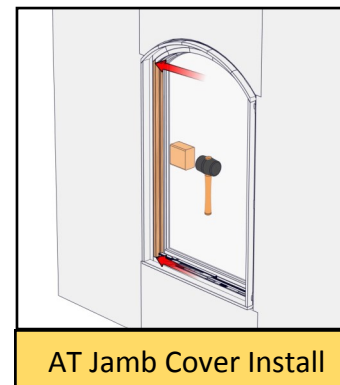

Cover Replacement (Continued)

- On Arch Top windows, using #2 Square drive bit, drive two (2) #8 x 1 ½" screws, FA7608SS, through screw holes in header and fasten header to frame.

Note:

- On all windows except Round-Top, jamb covers must be installed prior to installing the sill and header covers.

Round Top Only (Miter Joint Corners)

- Place Round Top head cover against frame head.
- Place strike-side jamb cover against end of head cover.
- While aligning jamb cover kerfs with wood connectors, use heel of hand or non-marking rubber mallet and a block of wood to seat jamb cover firmly against frame.
- Place opposite jamb cover against end of head cover (if previously removed).
- While aligning jamb cover kerfs with wood connectors, use heel of hand or non-marking rubber mallet and a block of wood to seat jamb cover firmly against frame near head.
- Place sill cover ends against jamb covers.
- Using heel of hand or non-marking rubber mallet and a block of wood, tap sill cover down, ensuring sill cover kerf aligns with wood connectors.

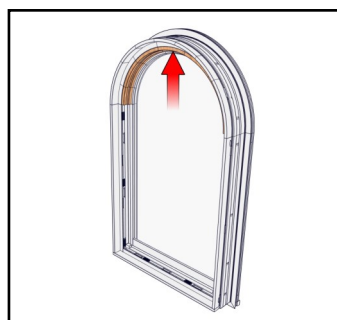

RT Head Cover Install

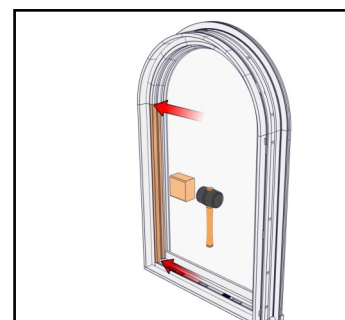

RT Jamb Cover Install

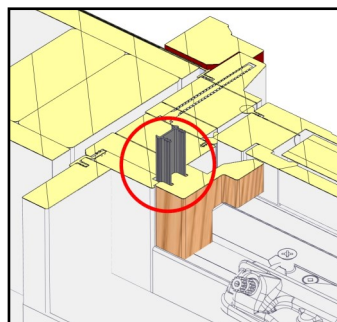

Jamb Cover With Kerf

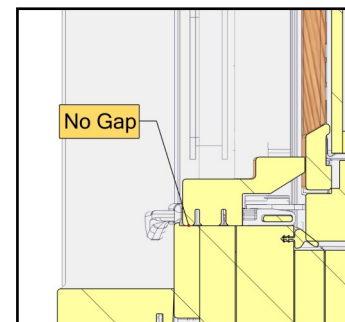

Jamb Cover Proper Gap

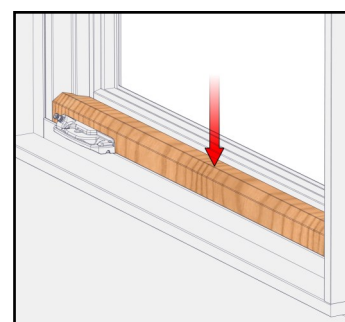

Sill Install

Note:

- For purposes of the hardware replacement described in this document, the Header Cover did not require removal for Round-Top Windows.

Cover Replacement (Continued)

Replace Operator Handle and Escutcheon

- Install operator escutcheon and handle.
- Ensure that handle folds into recess on escutcheon.
- Tighten set screw on handle.

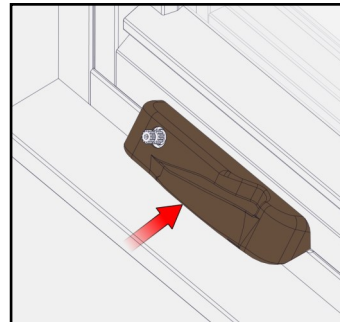

Escutcheon Install

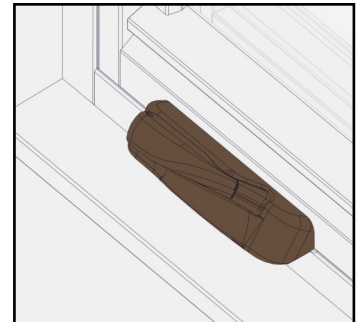

Handle Install



Incorrect Handle Install

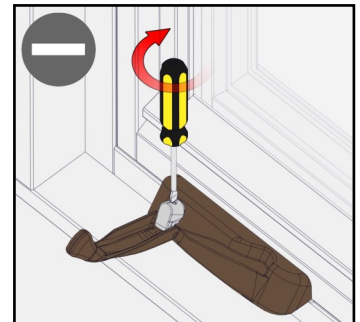

Secure Handle Set Screw

Replace Lock Handle and Escutcheon

- Install lock escutcheon and handle.
- Confirm lock/unlock with handle.

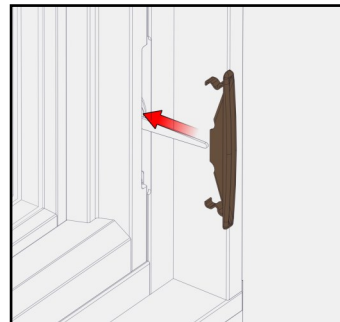

Escutcheon Install

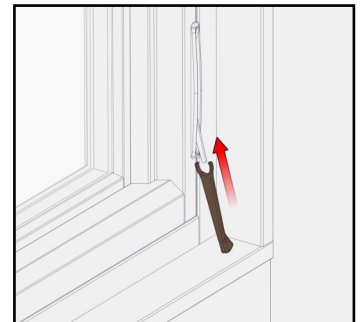

Handle Install

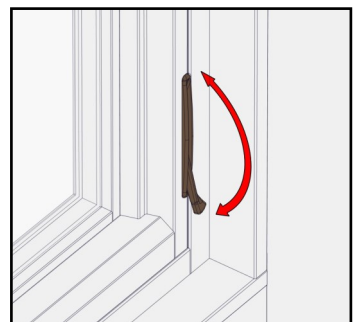

Lock / Unlock Motion

Frame Fascia Wood Removal

Removal

- Remove jamb, sill and header covers. (Refer to the removal procedure in this document)
- Using a putty knife, pry off the wood cover connectors VA7475, around the perimeter of the frame. Connectors may break and should be replaced.
- To minimize connector breakage, acetone can be used to break down the bond from connector to frame.
- At head, slip putty knife between wood frame and window frame.
- Pry wood frame outwards to unfasten all interlocking Dual-Lock fasteners along head.
- Remove fascia frame as one unit.

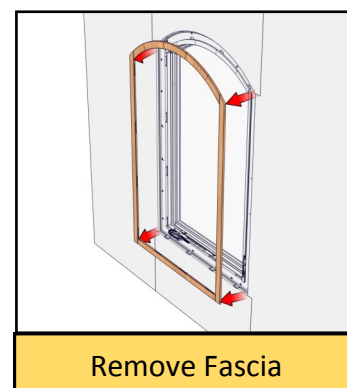
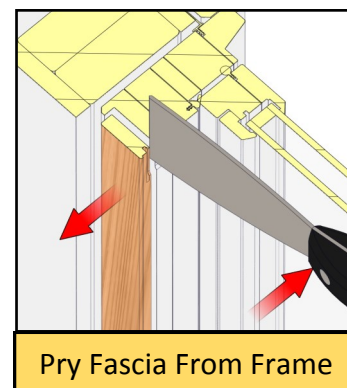
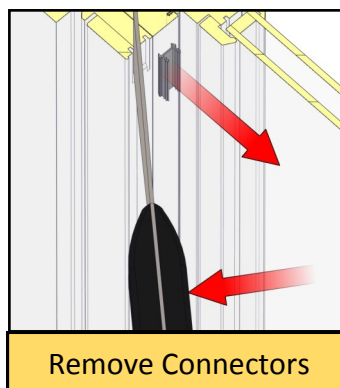

Note:

- ♦ Removal of the Wood Fascia Frame is not recommended. Staining or painting can be accomplished while attached to window. If window needs servicing and you must remove the Fascia Frame, use this procedure. The Wood Fascia Frame is pre-assembled as one unit. Do not attempt to remove only one section individually, or breakage will occur.

Frame Fascia Wood Replacement

Replacement

- Prior to replacing wood fascia frame, clean existing glue from wood cover connectors and window frame. Use acetone to clean.
- Place a drop of “Gel-type” superglue on the frame at each connector location.
- Place wood fascia frame against window frame, ensuring the inside edges of the fascia frame and the window frame are flush with each other.
- Using the heel of your hand or a non-marking rubber mallet, tap on the face of the frame header, seating the interlocking connectors.
- Snap wood cover connectors over fascia wood frame and window frame at slotted areas on the sill and stiles.
- Allow glue to set for 1-5 minutes.
- Replace Sill, Head and Jamb covers. (Refer to the procedure in this document)
- For Operable windows, re-attach lock escutcheon and handle and operator escutcheon and handle.

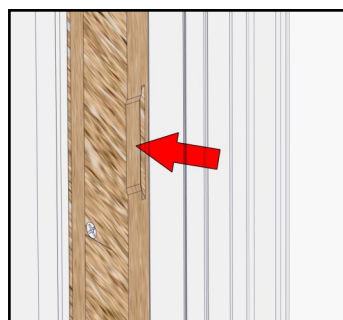

Glue Connector Locations

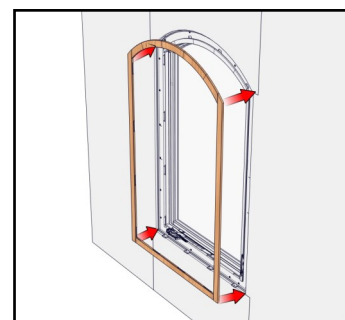

Fascia Install

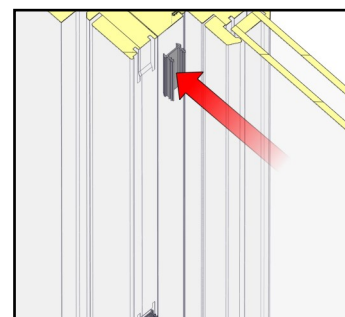

Install Connectors

Note:

- ◆ Replacement wood fascia frame and fasteners can be ordered through your local Milgard representative or by contacting your Milgard Windows and Doors dealer.

Wood Glazing Bead Removal

Removal

- Operable casement sash must be opened to perform this task.
- Ensuring window is unlocked, open window to half open (approximately).
- Place putty knife or flat head screwdriver between operator arm and slider track. Pry until slider is released from arm pin.
- Using a #2 Phillips Screwdriver, loosen three operator track mounting screws about 1/8".

Picture Window

- Remove Sill, Header and Jamb Covers per previous section in this manual.

All Windows

- Using an angled putty knife, near a corner, insert tool into the space between the glass and the wood glazing bead.
- Carefully, to keep from cracking glass, pry up on the glazing bead until the interlocking connectors release.
- Move tool further up edge of glazing bead, insert and pry again.
- Repeat until glazing bead pulls completely away from sash.

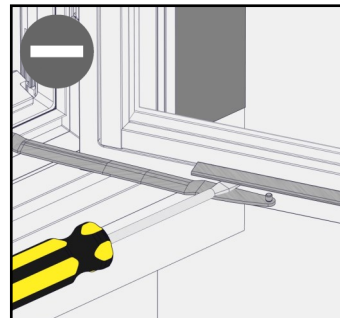

Track Disengagement

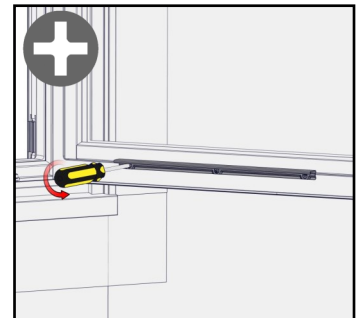

Loosen Screws

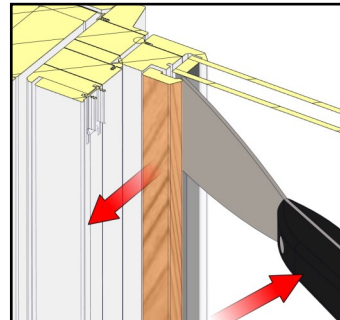

Pry Glazing Bead

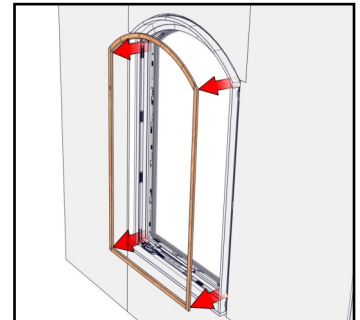

Remove Glazing Bead

Note:

- ♦ Grids are attached to glass via the vertical component(s) of grid. If grids are present, use the putty knife to separate the grid from the glass by prying grid away from glass until interlocking connectors release.

Wood Glazing Bead Replacement

Replacement

All Windows

- Position glazing bead on sash, ensuring the gaps, top to bottom and side to side are evenly spaced.
- Using the heel of your hand or a non-marking rubber mallet, tap around the perimeter of entire glazing bead to seat the interlocking connectors.

Operable Casement

- Using a #2 Phillips screwdriver, tighten 3 operator track mounting screws.
- Snap operator arm pin into track slider.
- Open and close window to ensure proper operation.

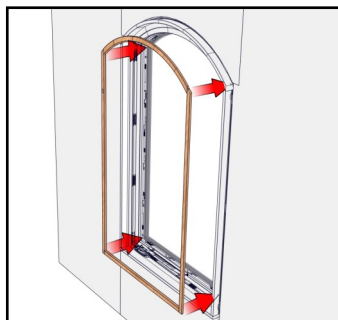

Install Glazing Bead

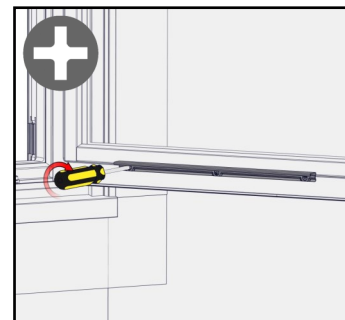

FA0480SS Install

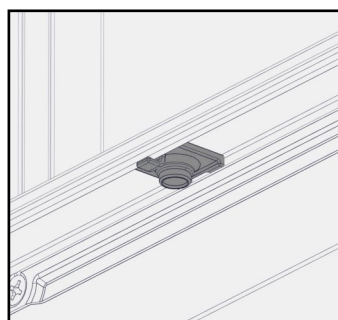

Track Slide

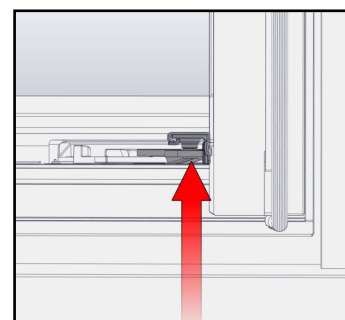

Track Engagement

Note:

- ♦ The Wood Glazing Bead, with and without Grids is pre-assembled as one unit. Do not attempt to remove only one section individually, or breakage will occur. Removal of sash is not required to perform this task. If preferred, sash can be removed. See LA7011 Hinge Adjustment and Replacement procedure, for removal and replacement of the sash. Hinge adjustment will be required if sash is removed.

Warning Injury or Damage:



- ♦ IF A STRONG WIND CATCHES UNSECURED WINDOW, DAMAGE TO WINDOW OR PERSONAL INJURY MAY OCCUR! If not removing sash, ensure the sash is secured after disconnecting operator arm from track. Milgard recommends reconnecting operator arm and locking window closed while performing maintenance on (removed) Glazing Bead.

Mullion Cover Removal and Replacement

Removal

- Using an angled putty knife, at one end of mullion, insert tool behind the wood mullion cover.
- Carefully, to keep from chipping or scratching wood fascia, pry up on the mullion cover until the interlocking connectors release.
- Move tool further up edge of cover, insert and pry again.
- Repeat until mullion cover pulls completely away from frame.

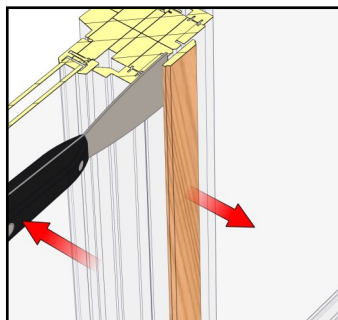

Pry Mull Cover

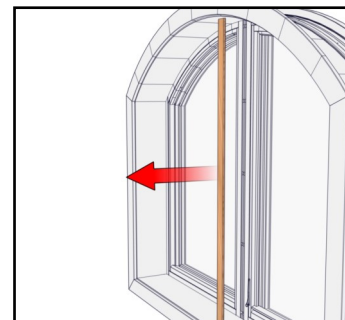

Remove Mull Cover

Replacement

- Position mullion cover on frame, ensuring the cover is centered over joined window frame edges.
- Using the heel of your hand or a non-marking rubber mallet, tap along the length of the mullion cover, to re-engage interlocking connectors.

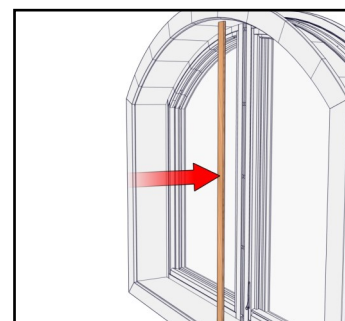

Replace Mull Cover



Clearly the best.

Revisions

REVISIONS					
REV	ECN	DESCRIPTION	DATE	DRAWN	APPD.
A	4278ECNEG	INITIAL RELEASE	09/06/2016	BBB	PK